

# Cascade Learning Resource Center

EvCC.edu/LRC

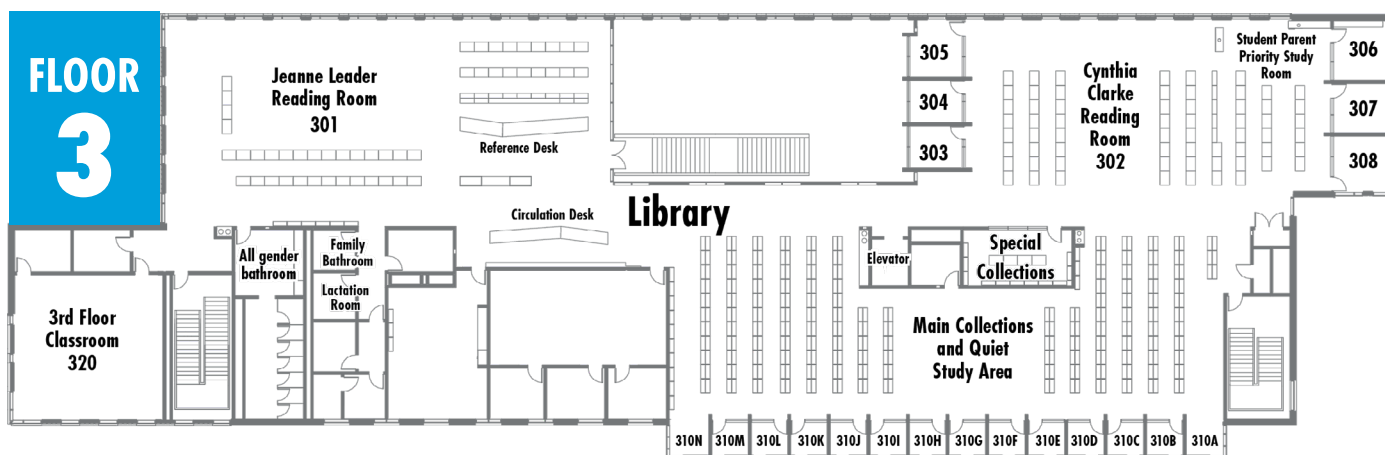
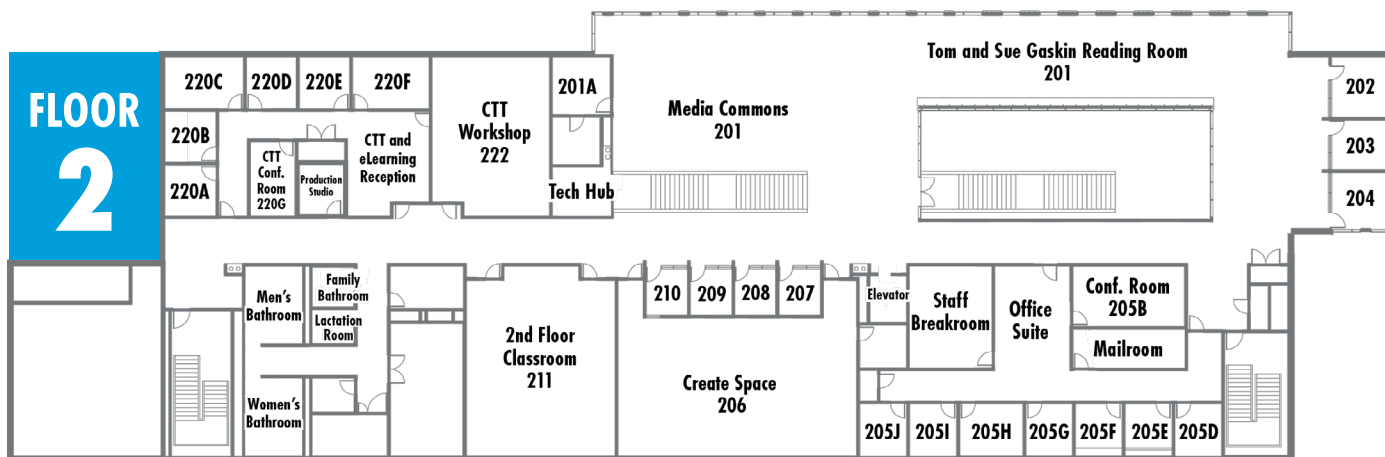
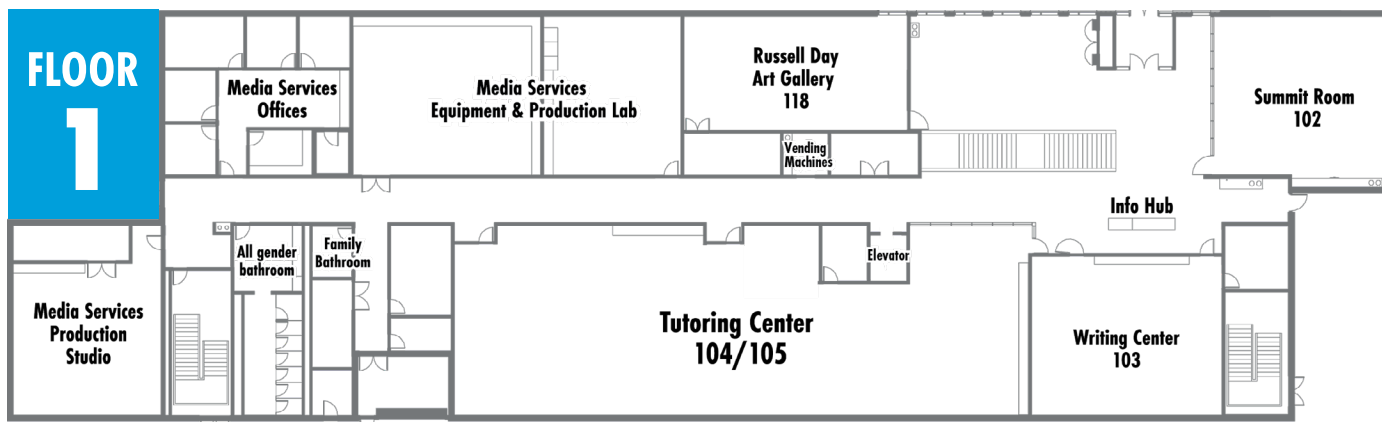

Everett Community College does not discriminate based on, but not limited to, race, color, national origin, citizenship, ethnicity, language, culture, age, sex, gender identity or expression, sexual orientation, pregnancy or parental status, marital status, actual or perceived disability, use of service animal, economic status, military or veteran status, spirituality or religion, or genetic information in its programs, activities, or employment. Contact the following people with inquiries or complaints regarding discrimination, Title IX compliance, or Americans with Disabilities Act compliance: Equal Opportunity Director: EqualOpportunity@everettcc.edu, 425-388-9271; ADA Coordinator: ADAcoordinator@everettcc.edu, 425-388-9232; Title IX Coordinator: TitleIXCoordinator@everettcc.edu, 425-388-9271. All offices are located in Olympus Hall 111, 2000 Tower St. Everett, WA 98201. For more information, visit the Equal Opportunity and Title IX website: [EverettCC.edu/EqualOpportunity](http://EverettCC.edu/EqualOpportunity)

# Cascade Learning Resource Center

## 1001 North Broadway

### 1st Floor

#### **Info Hub**

425-388-9069

#### **Tutoring Center**

CAS 104/105

425-388-9356 | tutoringcenter@everettcc.edu

#### **Media Services**

425-388-9350 | media@everettcc.edu

#### **Writing Center**

CAS 103

425-388-9406 | thewritingcenter@everettcc.edu

### 2nd Floor

#### **LRC Tech Support**

425-388-9170

#### **eLearning & Center for Transformative Teaching (CTT)**

CAS 220

425-388-9027 | elearning@everettcc.edu

#### **Create Space**

CAS 206

#### **Production Studio**

CAS 221

#### **Lightboard Studio**

CAS 206, Tool Room

### 3rd Floor

#### **Library:**

##### **Reference**

425-388-9354 | library@everettcc.edu

##### **Circulation**

425-388-9353 | circulation@everettcc.edu

Visit [EverettCC.edu/LRC](https://www.everettcc.edu/LRC) to learn more about our available services.